

CTT Terminations & Tooling

CTT PVC pre-insulated easy entry Terminals

Features

- Cable size stamped on palm
- Easy entry for quick cable insertion
- Wide size range
- 13 types available
- PVC insulation material as standard
- UL approved
- Brazed seam barrel as standard
- All dimensions shown are in millimetres

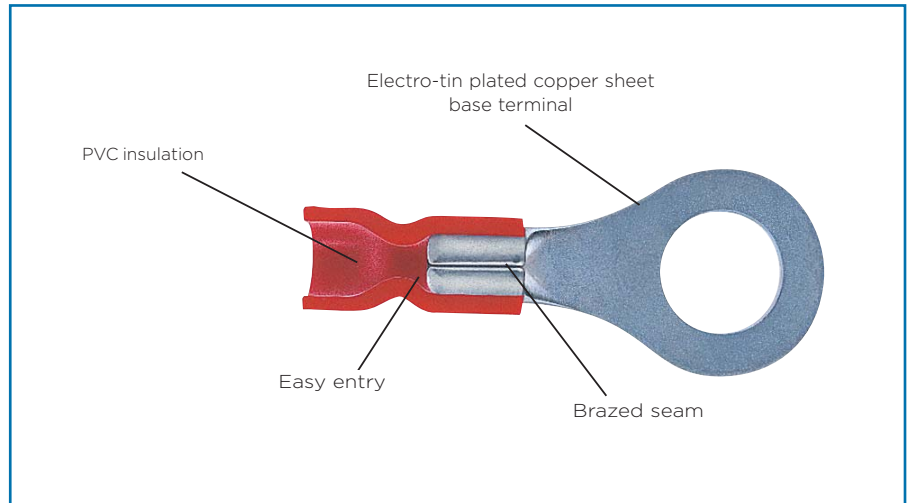

Easy entry terminals ensure all conductor strands are guided quickly and easily into the barrel of the terminal, creating a consistent connection, both electrically and mechanically.

PVC insulated easy entry terminations are available in 13 standard palm forms. Maximum working temperature of PVC insulation is 80°C.

Ring Terminals



Red 0.75-1.65mm² AWG 20-16
 Blue 1.04-2.63mm² AWG 16-14
 Yellow 2.63-6.64mm² AWG 12-10

	Stud Size	S	W	L	d	D	Part No
	3.0	3.2	5.5	17.5	1.7	4.1	R32PR
	3.5	3.7	5.5	17.5	1.7	4.1	R37PR
	4.0	4.3	6.6	20.4	1.7	4.1	R43PR
	5.0	5.3	8.0	21.8	1.7	4.1	R53PR
	6.0	6.4	11.6	27.5	1.7	4.1	R65PR
	8.0	8.4	11.6	27.5	1.7	4.1	R85PR
	10.0	10.5	13.7	31.5	1.7	4.1	R10PR
	12.0	13.0	19.3	38.0	1.7	4.1	R12PR
	3.0	3.2	6.6	20.6	1.7	4.5	B32PR
	3.5	3.7	6.6	20.6	1.7	4.5	B37PR
	4.0	4.3	6.6	20.6	2.3	4.5	B43PR
	5.0	5.3	8.5	23.0	2.3	4.5	B53PR
	6.0	6.4	12.0	28.0	2.3	4.5	B65PR
	8.0	8.4	12.0	28.0	2.3	4.5	B85PR
	10.0	10.5	13.6	31.7	2.3	4.5	B10PR
	12.0	13.0	19.0	35.2	2.3	4.5	B12PR
	3.0	3.2	9.5	26.7	3.4	6.6	Y32PR
	3.5	3.7	9.5	26.7	3.4	6.6	Y37PR
	4.0	4.3	9.5	26.7	3.4	6.6	Y43PR
	5.0	5.3	9.5	26.7	3.4	6.6	Y53PR
	6.0	6.4	12.0	32.7	3.4	6.6	Y65PR
	8.0	8.4	15.0	34.9	3.4	6.6	Y85PR
	10.0	10.5	15.0	34.9	3.4	6.6	Y10PR
	12.0	13.0	19.2	39.6	3.4	6.6	Y12PR

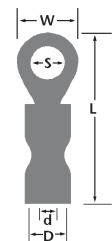

Tools

Suitable crimping tools CT6R (not recommended for continuous use with 6.0mm² wire.), RTB-510 System

For tools with single shot dies use:
 CT1.5VR Red
 CT2.5VR Blue
 CT6VR Yellow

CTT Terminations & Tooling

CTT PVC pre-insulated easy entry Terminals

Spade Terminals



Red 0.75-1.65mm² AWG 20-16
 Blue 1.04-2.63mm² AWG 16-14
 Yellow 2.63-6.64mm² AWG 12-10

	Stud Size	S	W	L	d	D	Part No
	3.0	3.2	5.7	22.0	1.7	4.1	R32PS
	3.5	3.7	5.7	22.0	1.7	4.1	R37NPS
	4.0	4.3	6.4	22.0	1.7	4.1	R43NPS
	4.0	4.3	7.2	22.5	1.7	4.1	R43PS
	5.0	5.3	8.0	22.5	1.7	4.1	R53PS
	6.0	6.4	10.7	23.0	1.7	4.1	R65PS
	3.0	3.2	5.7	22.5	2.3	4.5	B32PS
	3.5	3.7	6.2	22.5	2.3	4.5	B37NPS
	4.0	4.3	6.4	22.5	2.3	4.5	B43NPS
	4.0	4.3	7.2	22.5	2.3	4.5	B43PS
	5.0	5.3	8.0	22.5	2.3	4.5	B53PS
	6.0	6.4	10.8	23.5	2.3	4.5	B65PS
	3.5	3.7	8.1	26.7	3.4	6.6	Y37PS
	4.0	4.3	8.2	26.7	3.4	6.6	Y43PS
	5.0	5.3	9.0	26.7	3.4	6.6	Y53PS
	6.0	6.4	12.0	30.3	3.4	6.6	Y65PS

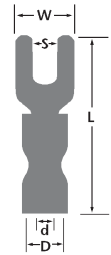

Tools
 Suitable crimping tools CT6R
 (not recommended for continuous use with 6.0mm² wire.),
 RTB-510 System

Pin Terminals



Red 0.75-1.65mm² AWG 20-16
 Blue 1.04-2.63mm² AWG 16-14
 Yellow 2.63-6.64mm² AWG 12-10

	PL	PD	L	d	D	Part No
	9.0	2.0	19.5	1.7	4.1	R95PP
	12.0	2.0	22.5	1.7	4.1	R12PP
	9.0	2.0	20.0	2.3	4.5	B95PP
	12.0	2.0	23.0	2.3	4.5	B12PP
	13.5	2.7	27.5	3.4	6.6	Y14PP

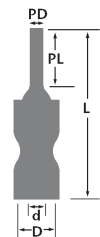

Tools
 Suitable crimping tools CT6R
 (not recommended for continuous use with 6.0mm² wire.),
 RTB-510 System

Blade Terminals



Red 0.75-1.65mm² AWG 20-16
 Blue 1.04-2.63mm² AWG 16-14
 Yellow 2.63-6.64mm² AWG 12-10

	BL	W	L	d	D	Part No
	9.0	2.30	19.4	1.7	4.1	R9PB
	14.5	3.00	25.5	1.7	4.1	R14PB
	18.0	2.45	28.5	1.7	4.1	R18PB
	9.0	2.80	20.0	2.3	4.5	B9PB
	18.0	2.45	29.0	2.3	4.5	B18PB
	10.0	2.80	24.0	3.4	6.6	Y10PB
	18.0	2.45	29.0	3.4	6.6	Y18PB

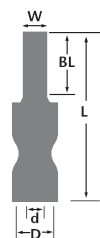

	BL	W	L	d	D	Part No
	13.0	3.0	27.2	1.7	4.1	R30PHBL
	13.0	3.0	27.2	2.3	4.5	B30PHBL

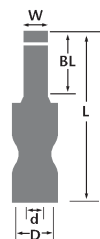

Available to special order:

	BL	W	L	d	D	Part No
	13.0	4.6	27.0	1.7	4.1	R46PHBL
	13.0	4.6	27.0	2.3	4.5	B46PHBL
	13.0	4.6	27.0	3.4	6.8	Y46PHBL

Tools
 Suitable crimping tools CT6R
 (not recommended for continuous use with 6.0mm² wire.),
 RTB-510 System

CTT Terminations & Tooling

CTT PVC pre-insulated easy entry Terminals

Push-on Terminals Male



Red 0.75-1.65mm² AWG 20-16
 Blue 1.04-2.63mm² AWG 16-14
 Yellow 2.63-6.64mm² AWG 12-10

	W x T	L	d	D	Part No
	6.3 x 0.8	22.0	1.8	3.6	R63PMPO
	6.3 x 0.8	22.5	2.4	4.3	B63PMPO
	6.3 x 0.8	24.5	3.5	5.7	Y63PMPO

Electro-tin plated brass

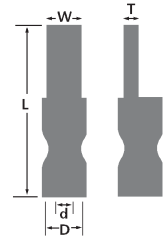

Tools

Suitable crimping tools CT6R (not recommended for continuous use with 6.0mm² wire.), RTB-510 System

Push-on Terminals: Female



Red 0.75-1.65mm² AWG 20-16
 Blue 1.04-2.63mm² AWG 16-14
 Yellow 2.63-6.64mm² AWG 12-10

	W x T	d	D	Part No
	2.8 x 0.5	1.8	3.6	R28PFPO
	2.8 x 0.8	1.8	3.6	R28PF POT
	4.8 x 0.5	1.8	3.6	R48PFPO
	4.8 x 0.8	1.8	3.6	R48PF POT
	6.3 x 0.8	1.8	3.6	R63PFPO
	4.8 x 0.5	2.4	4.3	B48PFPO
	4.8 x 0.8	2.4	4.3	B48PF POT
	6.3 x 0.8	2.4	4.3	B63PFPO
	6.3 x 0.8	3.5	5.7	Y63PFPO
	9.5 x 1.2	3.5	5.7	Y95PFPO

Electro-tin plated brass



Tools

Suitable crimping tools CT6R (not recommended for continuous use with 6.0mm² wire.), RTB-510 System

Fully insulated Push-on Terminals: Female



Red 0.75-1.65mm² AWG 20-16
 Blue 1.04-2.63mm² AWG 16-14
 Yellow 2.63-6.64mm² AWG 12-10

	W x T	d	D	Part No
	4.8 x 0.5	1.8	3.6	R48CPFPO
	4.8 x 0.8	1.8	3.6	R48CPF POT
	6.3 x 0.8	1.8	3.6	R63CPFPO
	4.8 x 0.5	2.4	4.3	B48CPFPO
	4.8 x 0.8	2.4	4.3	B48CPF POT
	6.3 x 0.8	2.4	4.3	B63CPFPO
	6.3 x 0.8	3.5	5.7	Y63CPFPO

Electro-tin plated brass



Tools

Suitable crimping tools CT6R (not recommended for continuous use with 6.0mm² wire.), RTB-510 System

Push-on (Piggyback) Adaptors: Male/Female



Red 0.75-1.65mm² AWG 20-16
 Blue 1.04-2.63mm² AWG 16-14
 Yellow 2.63-6.64mm² AWG 12-10

	W x T	L	d	D	Part No
	6.3 x 0.8	22.5	1.8	3.6	R63PPB
	6.3 x 0.8	23.0	2.4	4.3	B63PPB
	6.3 x 0.8	25.0	3.5	5.7	Y63PPB

Electro-tin plated brass

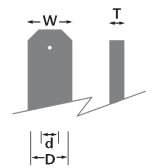

Tools

Suitable crimping tools CT6R (not recommended for continuous use with 6.0mm² wire.), RTB-510 System

CTT Terminations & Tooling

CTT PVC pre-insulated easy entry Terminals

Bullet Connectors



Red 0.75-1.65mm² AWG 20-16
Blue 1.04-2.63mm² AWG 16-14

Female

	BD x BL	L	d	D	Part No
	4.0 x 13.5	24.0	1.8	3.6	R40PFC
	4.0 x 13.5	24.0	2.4	4.3	B40PFC

Male

	BD x BL	L	d	D	Part No
	4.0 x 10.5	21.5	1.8	3.6	R40PMB
	4.0 x 10.5	21.5	2.4	4.3	B40PM

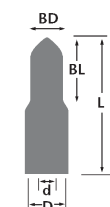
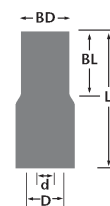

Tools

Suitable crimping tools CT6R (not recommended for continuous use with 6.0mm² wire.), RTB-510 System

Butt Connectors



Red 0.75-1.65mm² AWG 20-16
Blue 1.04-2.63mm² AWG 16-14
Yellow 2.63-6.64mm² AWG 12-10

	L	d	D	Part No
	24.0	1.7	4.0	RPBS
	25.0	2.3	4.5	BPBS
	27.0	3.4	6.6	YPBS

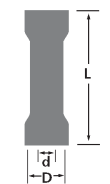

Tools

Suitable crimping tools CT6R (not recommended for continuous use with 6.0mm² wire.), RTB-510 System

Parallel Connectors



Red 0.75-1.65mm² AWG 20-16
Blue 1.04-2.63mm² AWG 16-14
Yellow 2.63-6.64mm² AWG 12-10

	L	d	D	Part No
	16.0	1.7	3.3	RPPS
	16.0	2.3	4.0	BPPS
	20.5	3.4	5.5	YPPS

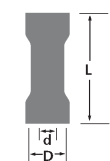

Tools

Suitable crimping tools CT6R (not recommended for continuous use with 6.0mm² wire.), RTB-510 System

CTT Terminations & Tooling

CTT Nylon pre-insulated easy entry Terminals

Features

- UL/CSA approved
- Cable size stamped on palm
- Easy entry for quick cable insertion
- Wide size range
- 12 types available
- Insulation material NYLON as standard
- All dimensions shown are in millimetres

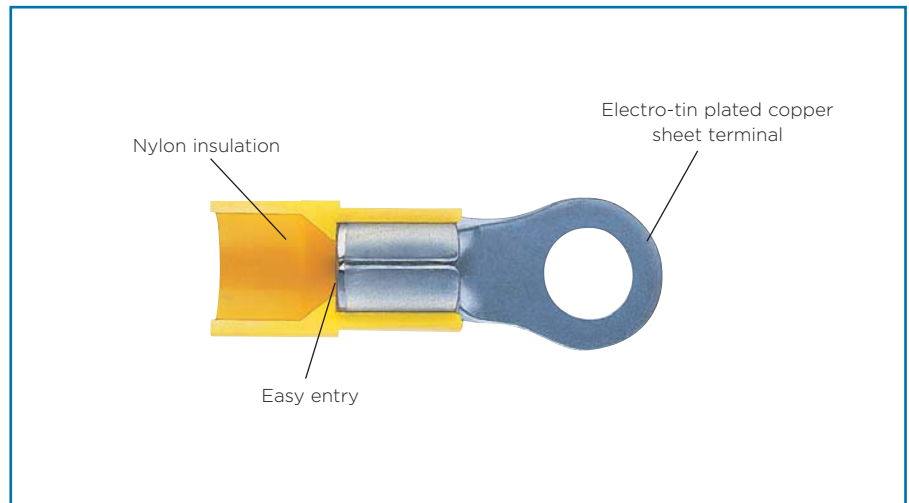

Nylon easy entry terminals are available for zero halogen and high temperature applications. Nylon insulated easy entry terminations

are available in 12 standard palm forms, including rings, spades, pins, blades etc. Maximum working temperature of Nylon insulation is 105°C.

Ring Terminals



Red 0.75-1.65mm² AWG 20-16
 Blue 1.04-2.63mm² AWG 16-14
 Yellow 2.63-6.64mm² AWG 12-10

	Stud Size	S	W	L	d	D	Part No
	3.0	3.2	5.5	17.5	1.7	4.1	R32PR-N
	3.5	3.7	5.5	17.5	1.7	4.1	R37PR-N
	4.0	4.3	6.6	20.4	1.7	4.1	R43PR-N
	5.0	5.3	8.0	21.8	1.7	4.1	R53PR-N
	6.0	6.4	11.6	27.5	1.7	4.1	R65PR-N
	8.0	8.4	11.6	27.5	1.7	4.1	R85PR-N
	10.0	10.5	13.7	31.5	1.7	4.1	R10PR-N
	3.0	3.2	6.6	20.6	2.3	4.5	B32PR-N
	3.5	3.7	6.6	20.6	2.3	4.5	B37PR-N
	4.0	4.3	6.6	20.6	2.3	4.5	B43PR-N
	5.0	5.3	8.5	23.0	2.3	4.5	B53PR-N
	6.0	6.4	12.0	28.0	2.3	4.5	B65PR-N
	8.0	8.4	12.0	28.0	2.3	4.5	B85PR-N
	10.0	10.5	13.6	31.7	2.3	4.5	B10PR-N
	3.0	3.2	9.5	26.7	3.4	6.6	Y32PR-N
	3.5	3.7	9.5	26.7	3.4	6.6	Y37PR-N
	4.0	4.3	9.5	26.7	3.4	6.6	Y43PR-N
	5.0	5.3	9.5	26.7	3.4	6.6	Y53PR-N
	6.0	6.4	12.0	32.7	3.4	6.6	Y65PR-N
	8.0	8.4	15.0	34.9	3.4	6.6	Y85PR-N
	10.0	10.5	15.0	34.9	3.4	6.6	Y10PR-N



Tools

Suitable crimping tools CT0760R, RTB-510 System

For tools with single shot dies use CT1.5VR Red, CT2.5VR Blue, CT6VR Yellow

CTT Terminations & Tooling

CTT Nylon pre-insulated easy entry Terminals

Spade Terminals



Red 0.75-1.65mm² AWG 20-16
 Blue 1.04-2.63mm² AWG 16-14
 Yellow 2.63-6.64mm² AWG 12-10

	Stud Size	S	W	L	d	D	Part No
	3.0	3.2	5.7	22.0	1.7	4.1	R32PS-N
	3.5	3.7	5.7	22.0	1.7	4.1	R37PS-N
	4.0	4.3	6.4	22.0	1.7	4.1	R43PS-N
	5.0	5.3	8.0	22.0	1.7	4.1	R53PS-N
	6.0	6.4	10.7	23.0	1.7	4.1	R65PS-N
	3.0	3.2	5.7	22.5	2.3	4.5	B32PS-N
	3.5	3.7	6.2	22.5	2.3	4.5	B37PS-N
	4.0	4.3	6.4	22.5	2.3	4.5	B43PS-N
	5.0	5.3	8.0	22.5	2.3	4.5	B53PS-N
	6.0	6.4	10.8	23.5	2.3	4.5	B65PS-N
	3.5	3.7	8.1	26.7	3.4	6.6	Y37PS-N
	4.0	4.3	8.2	26.7	3.4	6.6	Y43PS-N
	5.0	5.3	9.0	26.7	3.4	6.6	Y53PS-N
	6.0	6.4	12.0	30.3	3.4	6.6	Y65PS-N

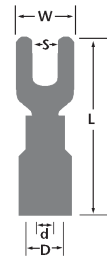

Tools
 Suitable crimping tools CT0760R, RTB-510 System

Pin Terminals



Red 0.75-1.65mm² AWG 20-16
 Blue 1.04-2.63mm² AWG 16-14
 Yellow 2.63-6.64mm² AWG 12-10

	PL	PD	L	d	D	Part No
	9.0	2.0	19.5	1.7	4.1	R95PP-N
	12.0	2.0	22.5	1.7	4.1	R12PP-N
	9.0	2.0	20.0	2.3	4.5	B95PP-N
	12.0	2.0	23.0	2.3	4.5	B12PP-N
	13.5	2.7	27.5	3.4	6.6	Y14PP-N



Tools
 Suitable crimping tools CT0760R, RTB-510 System

Flat Blade Terminals



Red 0.75-1.65mm² AWG 20-16
 Blue 1.04-2.63mm² AWG 16-14
 Yellow 2.63-6.64mm² AWG 12-10

	BL	W	L	d	D	Part No
	9.0	2.80	19.5	1.7	4.1	R9PBL-N
	14.5	3.00	25.0	1.7	4.1	R14PBL-N
	18.0	2.45	28.5	1.7	4.1	R18PBL-N
	9.0	2.80	20.0	2.3	4.5	B9PBL-N
	18.0	2.45	29.0	2.3	4.5	B18PBL-N
	10.0	2.80	24.0	3.4	6.6	Y10PBL-N
	13.0	4.50	27.0	3.4	6.6	Y18PBL-N

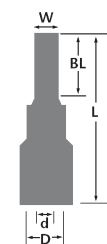

Tools
 Suitable crimping tools CT0760R, RTB-510 System

CTT Terminations & Tooling

CTT Nylon pre-insulated easy entry Terminals

Push-on Terminals: Female



Red 0.75-1.65mm² AWG 20-16
 Blue 1.04-2.63mm² AWG 16-14
 Yellow 2.63-6.64mm² AWG 12-10

	W x T	L	d	D	Part No
	2.8 x 0.5	18.5	1.8	3.6	R28PFPO-N
	2.8 x 0.8	18.5	1.8	3.6	R28PFPOT-N
	4.8 x 0.5	19.5	1.8	3.6	R48PFPO-N
	4.8 x 0.8	19.5	1.8	3.6	R48PFPOT-N
	6.3 x 0.8	21.5	1.8	3.6	R63PFPO-N
	4.8 x 0.5	20.0	2.4	4.3	B48PFPO-N
	4.8 x 0.8	20.0	2.4	4.3	B48PFPOT-N
	6.3 x 0.8	22.0	2.4	4.3	B63PFPO-N
	6.3 x 0.8	25.0	3.5	5.7	Y63PFPO-N

Electro-tin plated brass

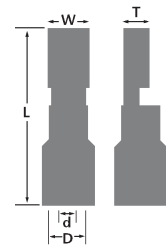

Tools
 Suitable crimping tools CT0760R, RTB-510 System

Fully insulated Push-on Terminals: Female



Red 0.75-1.65mm² AWG 20-16
 Blue 1.04-2.63mm² AWG 16-14
 Yellow 2.63-6.64mm² AWG 12-10

	W x T	L	d	D	Part No
	4.8 x 0.5	19.5	1.8	3.6	R48CPFPO-N
	4.8 x 0.8	19.5	1.8	3.6	R48CPFOT-N
	6.3 x 0.8	21.5	1.8	3.6	R63CPFPO-N
	4.8 x 0.5	20.0	2.4	4.3	B48CPFPO-N
	4.8 x 0.8	20.0	2.4	4.3	B48CPFOT-N
	6.3 x 0.8	22.0	2.4	4.3	B63CPFPO-N
	6.3 x 0.8	26.0	3.5	5.7	Y63CPFPO-N

Electro-tin plated brass

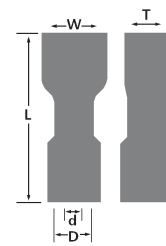

Tools
 Suitable crimping tools CT0760R, RTB-510 System

Push-on Terminals: Male



Red 0.75-1.65mm² AWG 20-16
 Blue 1.04-2.63mm² AWG 16-14
 Yellow 2.63-6.64mm² AWG 12-10

	W x T	L	d	D	Part No
	6.3 x 0.8	22.0	1.8	3.6	R63PMPO-N
	6.3 x 0.8	22.5	2.4	4.3	B63PMPO-N
	6.3 x 0.8	24.5	3.5	5.7	Y63PMPO-N

Electro-tin plated brass

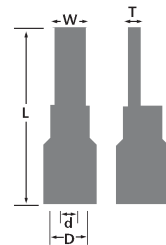

Tools
 Suitable crimping tools CT0760R, RTB-510 System

Push-on (Piggyback) Adaptors: Male/Female



Red 0.75-1.65mm² AWG 20-16
 Blue 1.04-2.63mm² AWG 16-14
 Yellow 2.63-6.64mm² AWG 12-10

	W x T	L	d	D	Part No
	6.3 x 0.8	22.5	1.8	3.6	R63PPB-N
	6.3 x 0.8	23.0	2.4	4.3	B63PPB-N
	6.3 x 0.8	26.0	3.5	5.7	Y63PPB-N

Electro-tin plated brass

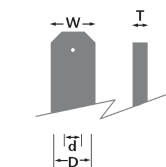

Tools
 Suitable crimping tools CT0760R, RTB-510 System

CTT Terminations & Tooling

CTT Nylon pre-insulated easy entry Terminals

Bullet Connectors



Red 0.75-1.65mm² AWG 20-16
 Blue 1.04-2.63mm² AWG 16-14
 Yellow 2.63-6.64mm² AWG 12-10

Female

	BL	W	L	d	D	Part No
	4.0	13.5	24.0	1.8	3.6	R40PFC-N
	4.0	13.5	24.0	2.4	4.3	B40PFC-N
	4.0	14.0	27.0	3.5	5.7	Y40PFC-N

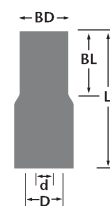

Male

	BL	W	L	d	D	Part No
	4.0	10.5	21.0	1.8	3.6	R40PMB-N
	4.0	10.5	21.5	2.4	4.3	B40PMB-N
	4.0	11.7	25.7	3.5	5.7	Y40PMB-N

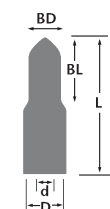

Tools

Suitable crimping tools CT0760R, RTB-510 System

Butt Connectors



Red 0.75-1.65mm² AWG 20-16
 Blue 1.04-2.63mm² AWG 16-14
 Yellow 2.63-6.64mm² AWG 12-10

	L	d	D	Part No
	25.6	1.7	4.1	RPBS-N
	25.3	2.3	4.5	BPBS-N
	27.5	3.4	6.6	YPBS-N

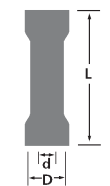

Tools

Suitable crimping tools CT0760R, RTB-510 System

Closed End Connectors



Red 0.75-1.75mm² AWG 20-16
 Blue 1.00-3.00mm² AWG 16-14
 Yellow 2.50-6.00mm² AWG 12-10

Conductor Size	L	d	D	Part No
0.5-1.75	14.0	2.4	6.5	RPES-N
1.0-3.00	15.5	3.1	8.0	BPES-N
2.5-6.00	17.0	3.9	10.8	YPES-N

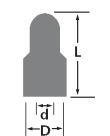

Tools

Suitable crimping tools CT0760R, RTB-510 System

CTT Terminations & Tooling

CTT NTM Vibration Resistant pre-insulated Nylon easy entry Terminals

Features

- Crimp performance to RSE/STD/024 Part 7
- PR VR Terminals are allocated London Underground and PADs Part Numbers required for Rail Industry use
- Strong mechanical grip on cable insulation
- Brazed seam barrel
- Suitable for any application subject to vibration
- UL/CSA/JIS approved
- Easy entry for quick cable insertion
- All dimensions shown are in millimetres



Ring Terminals



Red 0.75-1.50mm² AWG 22-16
 Blue 1.50-2.50mm² AWG 16-14
 Yellow 4.00-6.00mm² AWG 12-10

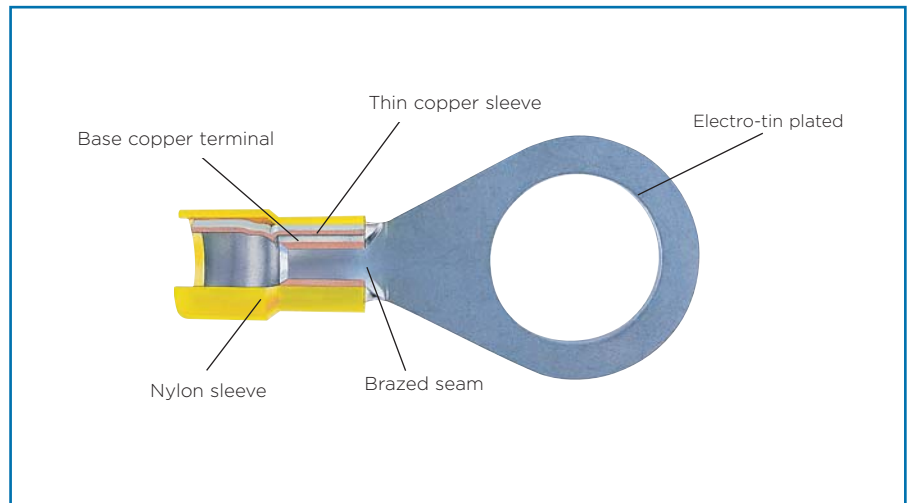

The vibration resistant terminal has an additional copper sleeve fitted over the conductor barrel. This provides a strong mechanical grip on the cable insulation and protects the electrical connection

from vibration and mechanical stresses. Vibration resistant pre-insulated terminals: insulating material is Nylon and maximum working temperature is 105°C.

	Stud Size	S	W	L	d	D	Part No
	3.5	3.7	6.8	19.4	1.7	3.6	R37PR-VR-N
	4.0	4.3	8.0	21.1	1.7	3.6	R43PR-VR-N
	5.0	5.3	8.0	21.1	1.7	3.6	R53PR-VR-N
	6.0	6.4	12.0	25.7	1.7	3.6	R65PR-VR-N
	8.0	8.4	12.0	25.7	1.7	3.6	R85PR-VR-N
	3.5	3.7	6.6	19.9	2.3	4.3	B37PR-VR-N
	4.0	4.3	8.0	21.6	2.3	4.3	B43PR-VR-N
	5.0	5.3	8.0	21.6	2.3	4.3	B53PR-VR-N
	6.0	6.4	12.0	27.0	2.3	4.3	B65PR-VR-N
	8.0	8.4	12.0	27.0	2.3	4.3	B85PR-VR-N
	10.0	10.5	15.0	30.0	2.3	4.3	B10PR-VR-N
	3.5	3.7	9.0	25.7	3.4	6.0	Y37PR-VR-N
	4.0	4.3	9.5	27.0	3.4	6.0	Y43PR-VR-N
	5.0	5.3	9.5	27.0	3.4	6.0	Y53PR-VR-N
	6.0	6.4	12.0	30.5	3.4	6.0	Y65PR-VR-N
	8.0	8.4	15.0	35.5	3.4	6.0	Y85PR-VR-N
	10.0	10.5	15.0	35.5	3.4	6.0	Y10PR-VR-N
	12.0	13.0	19.2	40.0	3.4	6.0	Y12PR-VR-N



Tools
 Suitable crimping tools
 Red CT1.5VR
 Blue CT2.5VR
 Yellow CT6VR
 RTB-510 System with vibration-resistant dies

CTT Terminations & Tooling

CTT NTM Vibration Resistant pre-insulated Nylon easy entry Terminals

Locking Spade Terminals



Red 0.75-1.50mm² AWG 22-16
 Blue 1.50-2.50mm² AWG 16-14
 Yellow 4.00-6.00mm² AWG 12-10

	Stud Size	S	W	L	d	D	Part No
	3.0	3.2	6.4	19.5	1.7	3.6	R32PLS-VR-N
	3.5	3.7	6.4	19.5	1.7	3.6	R37PLS-VR-N
	4.0	4.3	7.1	21.5	1.7	3.6	R43PLS-VR-N
	5.0	5.3	8.4	21.5	1.7	3.6	R53PLS-VR-N
	3.0	3.2	6.4	19.5	2.3	4.3	B32PLS-VR-N
	3.5	3.7	6.4	19.5	2.3	4.3	B37PLS-VR-N
	4.0	4.3	7.1	21.5	2.3	4.3	B43PLS-VR-N
	5.0	5.3	8.4	22.5	2.3	4.3	B53PLS-VR-N
	3.5	3.7	7.9	25.7	3.4	6.0	Y37PLS-VR-N
	4.0	4.3	7.9	25.7	3.4	6.0	Y43PLS-VR-N
	5.0	5.3	8.4	25.7	3.4	6.0	Y53PLS-VR-N

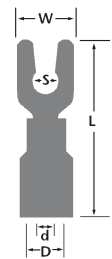

Tools
 Suitable crimping tools
 Red CT1.5VR
 Blue CT2.5VR
 Yellow CT6VR

RTB-510 System with vibration-resistant dies

Pin Terminals



Red 0.75-1.50mm² AWG 22-16
 Blue 1.50-2.50mm² AWG 16-14
 Yellow 4.00-6.00mm² AWG 12-10

	PL	PD	L	d	D	Part No
	12.0	1.9	21.2	1.7	3.6	R12PP-VR-N
	12.0	1.9	21.7	2.3	4.3	B12PP-VR-N
	14.0	2.7	26.5	3.4	6.0	Y14PP-VR-N



Tools
 Suitable crimping tools
 Red CT1.5VR
 Blue CT2.5VR
 Yellow CT6VR

RTB-510 System with vibration-resistant dies

Ring Tongue Terminals: Insulation Restricting

Wire Size (mm ²)	Tongue Material Thickness Max.	Stud Size	W	Dimension C	E	L	Terminal Insulation Colour	Wire Insulation Diameter	Part No Loose Piece
22 (0.38)	0.84	4	5.54	3.96	15.80	18.64	Red/Green	0.97 - 2.79	52273
		6 (M3.5)	5.54	3.96	15.80	18.64	Red/Green	0.97 - 2.79	2-36149-3
	0.79	6 (M3.5)	6.35	6.35	18.19	21.44	Red/Green	0.97 - 2.79	51863-2
		8 (M4)	7.92	7.14	18.97	23.01	Red/Green	0.97 - 2.79	1-320551-2
20 (0.60)	0.84	4	5.54	3.96	15.80	18.64	Red/Red	1.17 - 2.79	52273-1
		6 (M3.5)	5.54	3.96	15.80	18.64	Red/Red	1.17 - 2.79	2-36149-4
	0.79	8 (M4)	7.92	7.14	18.97	23.01	Red/Red	1.17 - 2.79	1-320551-3
		10	7.92	7.14	18.97	23.01	Red/Red	1.17 - 2.79	2-36153-4
18 (1.42)	0.84	4	5.54	3.96	15.80	18.64	Red/White	1.42 - 2.79	52273-2
		6 (M3.5)	5.54	3.96	15.80	18.64	Red/White	1.42 - 2.79	2-36149-5
	0.79	6 (M3.5)	6.35	6.35	18.19	21.44	Red/White	1.42 - 2.79	51863-4
		10	7.92	7.14	18.97	23.01	Red/White	1.42 - 2.79	2-36153-5
16 (1.42)	0.84	6 (M3.5)	6.35	4.34	16.18	19.43	Blue/Blue	1.60 - 3.30	2-320561-3
		8 (M4)	7.92	7.14	18.97	23.01	Blue/Blue	1.60 - 3.30	1-51864-0
		10	7.92	7.14	18.97	23.01	Blue/Blue	1.60 - 3.30	51864-7
14 (2.15)	0.84	6 (M3.5)	7.92	7.14	18.97	23.01	Blue/Green	1.98 - 3.30	51864-8
		8 (M4)	7.92	7.14	18.97	23.01	Blue/Green	1.98 - 3.30	1-51864-1
		10	7.92	7.14	18.97	23.01	Blue/Green	1.98 - 3.30	51864-9
12 (3.37)	1.07	8 (M4)	9.53	7.67	24.33	29.16	Yellow/Yellow	2.41 - 5.08	2-320568-2
		10	9.53	7.67	24.33	29.16	Yellow/Yellow	2.41 - 5.08	2-36161-3
10 (6.11)	1.07	8 (M8)	9.53	7.67	24.33	29.16	Yellow/Brown	3.02 - 5.08	2-320568-3

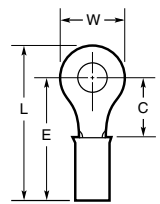

CTT Terminations & Tooling

CTT NTM Vibration Resistant pre-insulated Nylon easy entry Terminals

Flat Blade Terminals



Red 0.75-1.50mm² AWG 22-16
 Blue 1.50-2.50mm² AWG 16-14
 Yellow 4.00-6.00mm² AWG 12-10

	BL	W	L	d	D	Part No
	10.5	2.2	20.5	1.7	3.6	R10PBL-VR-N
	18.5	2.2	28.5	1.7	3.6	R18PBL-VR-N
	9.1	2.8	19.1	2.3	4.3	B9PBL-VR-N
	18.5	2.2	28.5	2.3	4.3	B18PBL-VR-N
	10.0	2.8	24.0	3.4	6.0	Y10PBL-VR-N
	18.0	4.5	32.0	3.4	6.0	Y18PBL-VR-N

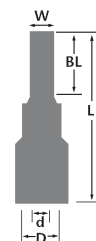

Tools

Suitable crimping tools
 Red CT1.5VR
 Blue CT2.5VR
 Yellow CT6VR
 RTB-510 System with vibration-resistant dies

Hooked Blade Terminals



Red 0.75-1.50mm² AWG 22-16
 Blue 1.50-2.50mm² AWG 16-14
 Yellow 4.00-6.00mm² AWG 12-10

	BL	W	L	d	D	Part No
	17.0	3.0	27.0	1.7	3.6	R30PHBL-VR-N
	17.0	4.6	27.0	1.7	3.6	R46PHBL-VR-N
	17.0	3.0	27.0	2.3	4.3	B30PHBL-VR-N
	17.0	4.6	27.0	2.3	4.3	B46PHBL-VR-N
	17.0	4.6	31.0	3.4	6.0	Y46PHBL-VR-N



Tools

Suitable crimping tools
 Red CT1.5VR
 Blue CT2.5VR
 Yellow CT6VR
 RTB-510 System with vibration-resistant dies

Push-on Terminals: Female



Red 0.75-1.50mm² AWG 22-16
 Blue 1.50-2.50mm² AWG 16-14
 Yellow 4.00-6.00mm² AWG 12-10

	W x T	L	d	D	Part No
	2.8 x 0.5	17.5	1.8	3.2	R28PFPO-VR-N
	2.8 x 0.8	17.5	1.8	3.2	R28PFOT-VR-N
	4.8 x 0.5	19.5	1.8	3.2	R48PFPO-VR-N
	4.8 x 0.8	19.5	1.8	3.2	R48PFOT-VR-N
	6.3 x 0.8	21.0	1.8	3.2	R63PFPO-VR-N
	4.8 x 0.5	19.5	2.4	3.9	B48PFPO-VR-N
	4.8 x 0.8	19.5	2.4	3.9	B48PFOT-VR-N
	6.3 x 0.8	21.0	2.4	3.9	B63PFPO-VR-N
	6.3 x 0.8	26.0	3.5	5.4	Y63PFPO-VR-N
	9.5 x 1.2	31.0	3.5	5.4	Y95PFPO-VR-N

Electro-tin plated brass



Tools

Suitable crimping tools
 Red CT1.5VR
 Blue CT2.5VR
 Yellow CT6VR
 RTB-510 System with vibration-resistant dies

CTT Terminations & Tooling

CTT NTM Vibration Resistant pre-insulated Nylon easy entry Terminals

Fully insulated Push-on Terminals: Female



Red 0.75-1.50mm² AWG 22-16
 Blue 1.50-2.50mm² AWG 16-14
 Yellow 4.00-6.00mm² AWG 12-10

	W x T	L	d	D	Part No
	6.3 x 0.8	21.0	2.1	3.2	R63CPFPO-VR-N
	6.3 x 0.8	21.0	2.8	3.9	B63CPFPO-VR-N
	6.3 x 0.8	26.0	3.5	5.4	Y63CPFPO-VR-N

Electro-tin plated brass

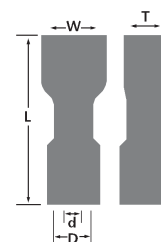

Tools

Suitable crimping tools
 Red CT1.5VR
 Blue CT2.5VR
 Yellow CT6VR
 RTB-510 System with vibration-resistant dies

Push-on Terminals: Male



Red 0.75-1.50mm² AWG 22-16
 Blue 1.50-2.50mm² AWG 16-14
 Yellow 4.00-6.00mm² AWG 12-10

	W x T	L	d	D	Part No
	6.3 x 0.8	21.0	1.85	3.2	R63PMPO-VR-N
	6.3 x 0.8	21.0	2.55	3.9	B63PMPO-VR-N
	6.3 x 0.8	26.0	3.65	5.4	Y63PMPO-VR-N

Electro-tin plated brass

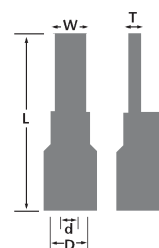

Tools

Suitable crimping tools
 Red CT1.5VR
 Blue CT2.5VR
 Yellow CT6VR
 RTB-510 System with vibration-resistant dies

Push-on (Piggyback) Adaptors: Male/Female

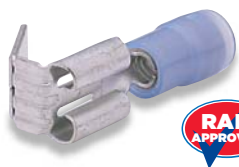

Red 0.75-1.50mm² AWG 22-16
 Blue 1.50-2.50mm² AWG 16-14

	W x T	L	d	D	Part No
	6.3 x 0.8	22.0	1.85	3.2	R63PPB-VR-N
	6.3 x 0.8	22.0	2.55	3.9	B63PPB-VR-N

Electro-tin plated brass

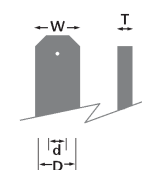

Tools

Suitable crimping tools
 Red CT1.5VR
 Blue CT2.5VR
 RTB-510 System with vibration-resistant dies